

Standard Wiring Diagram – T03543 – Key Switch

Key operated switch; for changing switch contacts state through operation of a key

The image below shows the switch state with key trapped. Safety circuit contacts are connected via terminals **21,23,25,27** (normally closed). Monitoring contacts are connected between terminals **22 & 24** (normally open) to detect when key is released.

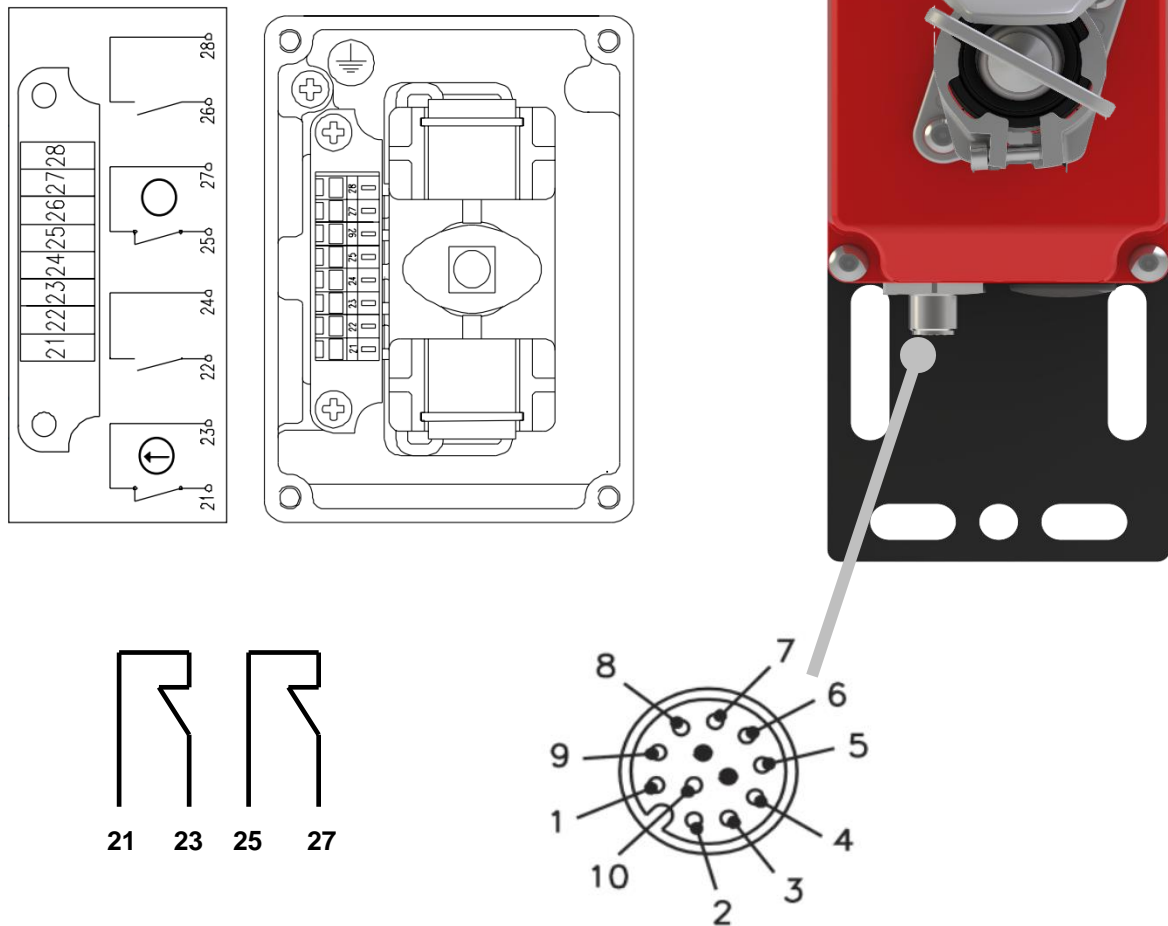

Description	Fortress Terminal	LH QD		RH QD	
		Colour	Pin	Colour	Pin
Earth	POD Case	GREEN	3		
+ve	22	BROWN	2		
SS1 Key Switch	21	BLUE	7		
SS1 Key Switch	23	TAN	10		
SS2 Key Switch	25	PINK	6		
SS2 Key Switch	27	WHITE	1		
Key Switch Monitor	24	GREY	5		
<i>Not used</i>		ORANGE	9		
<i>Not used</i>		YELLOW	4		
<i>Not used</i>		RED	8		